

**From:** [John Coates](#)  
**To:** [A47-A11 Thickthorn](#)  
**Subject:** TR010037 - A47/A11 Thickthorn Junction  
**Date:** 21 September 2021 11:46:25  
**Attachments:** [Scan\\_17351.pdf](#)

---

Dear Sirs

I write further to the comments made by Matthew Shrigley at the Preliminary Meeting on Monday 13 September 2021 where he confirmed receipt of my email of 25 August, below, and stated that Interested parties are requested to suggest locations (with justification) for the Planning Inspectorate to visit by no later than 13 October.

Attached is a plan showing my Clients' property, [REDACTED], onto which I have drawn a route, in red, which I suggest the Examining Authority (EA) should take. I have also marked some points on the plan which I now refer to:

- Point 1. Depending on the number of people attending the visit, this would be a suitable location to park cars.
- Points 1 to 2. An opportunity for the EA to view the water meadow that will be dissected by the new Cantley Lane Link Road south of the A11 and the access track to my client's land through the trees to the north, that will be lost.
- Point 3. An opportunity for the EA to appreciate the negative impact of the road improvements on a picturesque range of barns that are suitable for conversion to residential use.
- Point 4. The best location from which to access (the accessible parts of) the proposed route of the A11-A47 slip road and understand its impact on the property here.
- Points 4 to 5. The approximate route of the new Cantley Lane Link Road north of the A11 from which its impact on the surrounding property can be better understood.
- Point 6. A sensible position from which the EA can gain an appreciation of the volume of traffic that makes use of the B1172 Norwich Road and understand the issues which vehicles, trying to turn right from the B1172 into the new Cantley Lane Link Road or right from the new Cantley Lane Link Road onto the B1172, might experience. I would suggest that you time your visit so as to coincide your arrival at Point 6 with rush hour.

We do not believe that a proper understanding of the proposed improvements, nor an appreciation of their impact on my Clients' property, can be achieved without the EA making a visit to the [REDACTED] and including, within that visit, the route I have suggested at the very least.

I trust this is all clear and acceptable but please do not hesitate to contact me should you have any queries; concerns or requests.

Many thanks

Yours sincerely

John



---

**John Coates**  
Associate, Rural

16 Upper King Street, Norwich, Norfolk. NR3 1HA  
DD: [REDACTED] | [bidwells.co.uk](http://bidwells.co.uk)

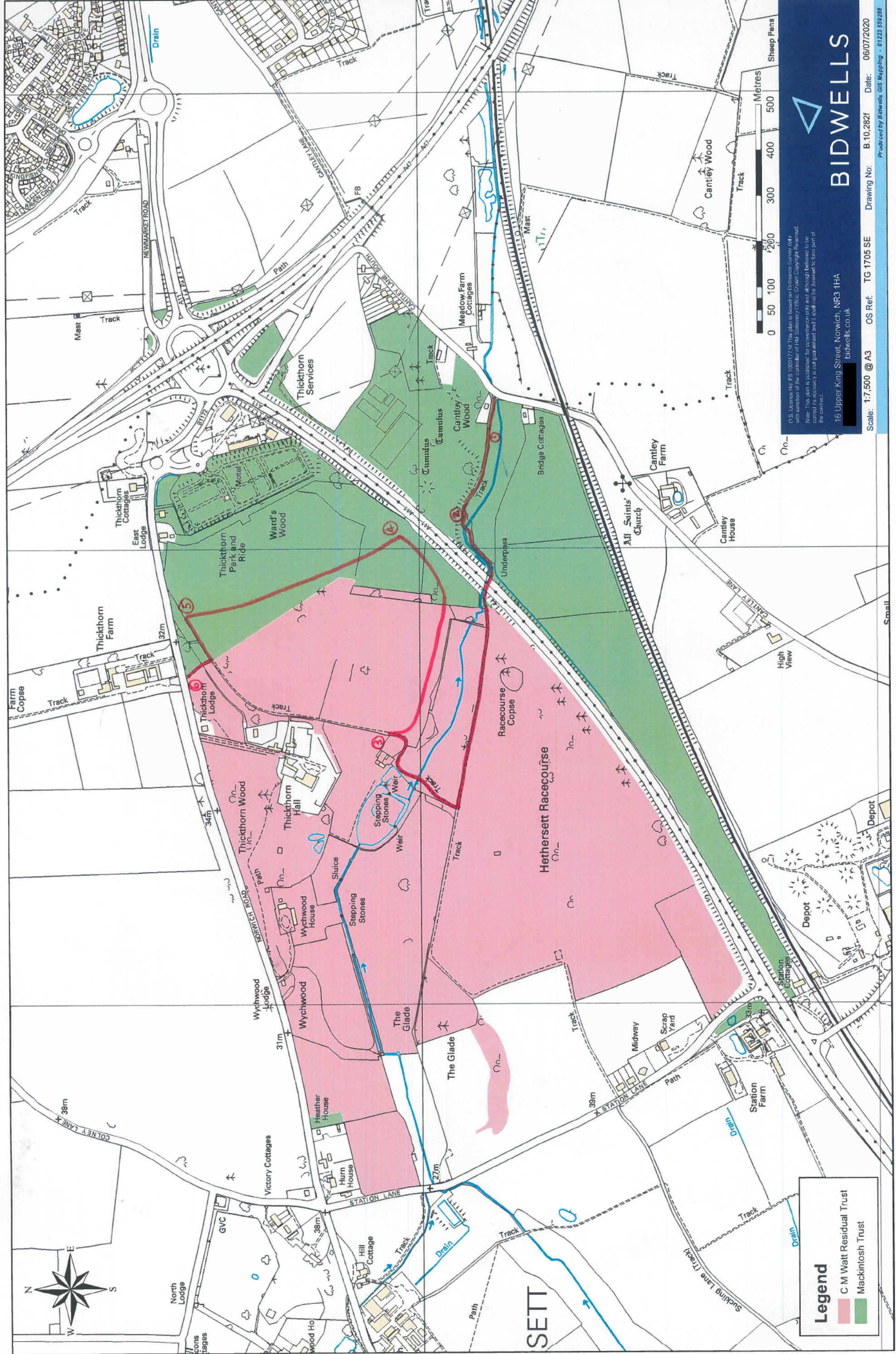

O.S. Licence No. FS 1000177/34. This plan is based on Ordnance Survey data with sanction of the Controller of HM Stationery Office. Crown Copyright Reserved. Note: This plan is published for convenience only and although believed to be correct its accuracy is not guaranteed and it shall not be deemed to form part of the contract.

16 Upper King Street, Norwich, NR3 1HA  
bidwells.co.uk

**BIDWELLS**

Scale: 1:7,500 @ A3 OS Ref. TG 1705 SE Drawing No. B.10.282f Date: 06/07/2020  
Produced by Bidwells GIS Mapping - 01223 559288

**Legend**

- C M Watt Residual Trust
- Mackintosh Trust

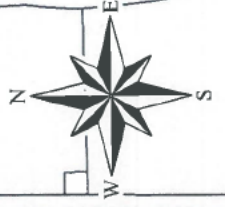

SETT